

CURVED GLASS MEAT DISPLAY CHILLER

Stainless Steel Series

Temp: $+2^{\circ}\text{C}$ to $+5^{\circ}\text{C}$

REFRIGERATION SYSTEM

Refrigeration system uses R134a
With all environmental concerns
Automatic, non-electric evaporator
Under neath chilled storage system
Epoxy coated evaporator coil
Evaporating tempeature -5°C

OPTIONS & ACCESSORIES

Stainless steel interior
Solid door(s)
Color choice
RED, GREEN, BLUE, WHITE
Price tag Shelf



Refrigerant: CFC Free 134a

1 Year Compressor Standard Warranty

CABINET CONSTRUCTION

Stainless steel front, sides, top, door(s), (*galvanized steel bottom*)
Interior liner is made of food grade stainless steel
Digital temperature controller
Chiled storage under neath
Interior thermometer is standard
Self-closing doors with 120° stay-open feature, on cartridge style hinges
Easy door removal for service and cleaning
Gasket attached to each door for positive seal
3" Casters, two (2) with brakes standard
Chiller operates at $+3^{\circ}\text{C}$ to $+5^{\circ}\text{C}$ for optimum food preservation

Units pre-wired at
factory and include 8'
long cord and plug set

Manufactured by:

TECHNO SIGHT

1066, Opposite PCSIR staff, Near Ameer chowk, College road, Township, Lahore-Pakistan.
WEBSITE: www.technosight.com.pk **EMAIL:** info@technosight.com.pk **PHONE:** 0423 512 43 44



CURVED GLASS MEAT DISPLAY CHILLER

DRAWING AND SPECIFICATION SHEET

MD 12

MODEL VIEWS

EXTERNAL DIMENSIONAL DATA

Overall Length	72"
Overall width	41.5"
Height Overall with 4" casters	50"
Number of Doors	2
Depth with Door Open 90°	63"
Door Opening each (in)	10" x 22"

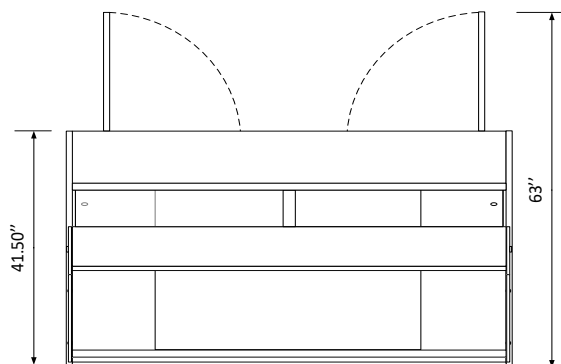

TOP VIEW

INTERNAL DIMENSIONAL DATA

Storage Capacity (cubic ft.)	8
Meat Display Area (sq. in)	2000
Display shelf usable Depth (in)	29"
Display shelf usable length (in)	69"
Number of Shelves	1

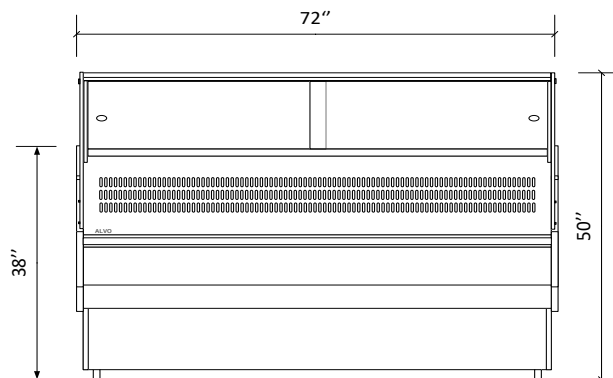

FRONT VIEW

ELECTRICAL DATA

Full Load Amperes	1
V 220/ HZ 50/ 1 PH	

REFRIGERATION DATA

Horsepower	0.75
Capacity (BTU/Hr)*	993

WEIGHT DATA

Gross Weight (Crated kg)	
Height - Crated	
Width - Crated	
Depth - Crated	

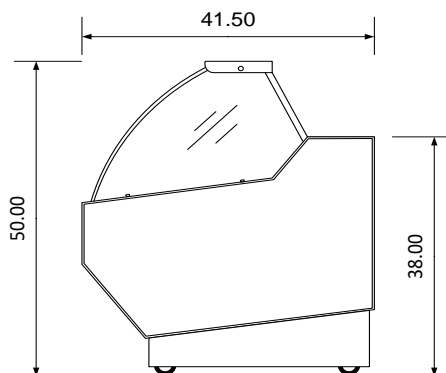

SIDE VIEW

NEED SUPPORT ? PLEASE CALL AT 03061000081

Manufactured by:



1066, Opposite PCSIR staff, Near Ameer chowk, College road, Township, Lahore-Pakistan.

WEBSITE: www.technosight.com.pk **EMAIL:** info@technosight.com.pk **PHONE:** 0423 512 43 44

